

www.nobleliftna.com

NOBLELIFT
NORTH AMERICA

LITHIUM-ION

FE4P50Q-70Q

5,000 - 7,000 lbs. Capacity

Four Wheel Lithium-Iron Forklift



Why choose between price and quality **WHEN YOU CAN HAVE BOTH!**



HIGHLIGHTS

- ▶ Powerful high quality AC drive system
- ▶ Infinitely variable hydraulic control speeds
- ▶ On-demand fully hydrostatic power steering (FHPS)
- ▶ 4-Way proportional hydraulic control valve
- ▶ Multi-function LED Display: parking brake, the driving direction and speed, the hour meter and the fault code
- ▶ Deluxe suspension seat
- ▶ Tilt steering column
- ▶ Intelligent Monitoring System (IMS) display indicators
- ▶ CAN-bus communications system
- ▶ On-board self-diagnostics
- ▶ Operator presence sensing system
- ▶ Safety Blue light and rear work light
- ▶ All-around front wheel drive
- ▶ Side extraction battery

FE4P50Q-70Q

5,000 - 7,000 lbs. Capacity

Four Wheel Lithium-Iron Forklift

The FE4P50Q-70Q Series are highly efficient, durable Lithium-iron forklifts. They are designed for indoor and outdoor applications. The mast system, front/rear axles and chassis are engineered to be tough like an Internal Combustion forklift, but with all the advantages of Lithium-iron. AC drive technology is used to achieve high performance with low operating and maintenance costs. Greatly increase your work productivity with these quiet, very low maintenance, ultra-smooth, lithium-iron forklifts.

EASY OPERATION AND GREAT VISIBILITY



Ergonomic U-shaped steering wheel with knob, together with hydraulic controls, provide comfortable and effortless operation.



The large, ergonomic cab and user-friendly design ensures operator comfort throughout the entire work shift.

Deluxe suspension, fully adjustable seat reduces vibration to the driver to effectively reduce driver fatigue for all sizes of operators.



Ratchet parking brake allows the truck to safely park on a slope of 15%.

Mast layout is optimized for a wide view and clear visibility while operating. Intelligent buffering when descending to the ground, effectively protects the ground and cargo from damage.

SUPERIOR DESIGN AND PERFORMANCE

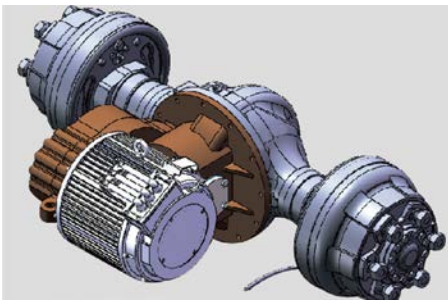

The drive system's horizontal fan-shaped axle and large transmission, coupled with the battery location and long wheelbase (67 inches), provide superior stability. The system is powered by a maintenance-free AC drive motor.

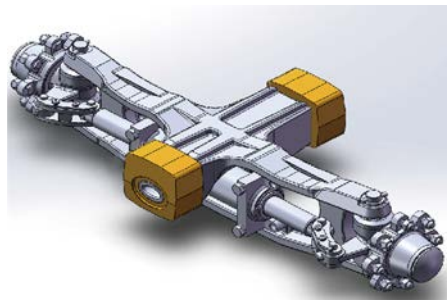

Steering axle with shock mitigation system is designed to protect the vehicle and prolong the service life of the forklift. It also provides the operator with smooth driving comfort.



Large ergonomically designed LED display provides easy control and operation, while providing truck status information: parking brake, the driving direction and speed, the hour meter and the fault code.



Large diameter, solid pneumatic tires ensure comfortable driving for outdoor and indoor use.



Lifting motor location allows truck to work in applications where there is water on the ground.



Controller assembly location provides easy maintenance and excellent ventilation.

HIGH EFFICIENCY AND SAFE LITHIUM-ION POWER

NOBLELIFT uses Lithium-Iron Phosphate batteries, the longest lasting and safest lithium-ion battery available. Our lithium-iron batteries are equipped with a Battery Management System (BMS), thermal management system, and an automotive-grade DC high-voltage control system. BMS manages charging and discharging data to ensure safety throughout its life cycle.

FE4P50Q-70Q forklifts have a 10 year or 20,000 hours warranty on the lithium-Iron battery.



ADVANTAGES OF LITHIUM-ION POWER



Fast-charging maintenance-free Lithium-Iron battery is fully charged in 2-3 hours. Battery can be opportunity charged during user breaks and during shift changes which allows the truck to run continuously through multi-shift operations. No battery changes are necessary.

LITHIUM BATTERY ADVANTAGES

Lead-Acid Battery

Lower fleet availability - Work is interrupted because battery needs to be fully charged before next use

Periodic battery replacement

Outsourced or in-house maintenance personnel required

8-10 Hours - 2 or more batteries per lift truck

Build an expensive battery room with ventilation

Releases hydrogen while charging - Can result in explosion - Acid burns can happen during maintenance

Power loss

Lithium Battery

100% Fleet availability - Opportunity charging allows battery to be charged in between use

Batteries last 3 times longer and do not need to be replaced

No maintenance cost

2-3 Hours - 1 Battery per lift truck

No battery room needed

No dangerous substances

No power loss - Reduces energy consumption by 35%

TOTAL COST OF OWNERSHIP

UP TO
47%
SAVINGS OVER 5 YEARS

Opportunity Charging Increases Productivity

Lithium Battery Acquisition Cost

Electric Cost

Maintenance Cost

Lead-Acid Battery Acquisition Cost

Electric Cost

Maintenance Cost

Battery Changing, Extra Batteries, Dedicated Battery Room

Internal Combustion Acquisition Cost

Fuel Cost

Maintenance Cost

Mast Table FE4P50Q						
Designation	Lift height h3 (in)	Free lift h2 (in)	Closed mast height h1 (in)	Extended mast height h4 (in)	Tilt forward / backward a/b (°)	Capacity table (lb) C=24in without sideshift single pneumatic tires
	FE4P50Q	FE4P50Q	FE4P50Q	FE4P50Q	FE4P50Q	FE4P50Q
Two-stage ZT	79	5.3	61.8	117.1	6 / 10	5,000
	98	5.3	71.7	136.8	6 / 10	5,000
	118	5.3	81.5	156.5	6 / 10	5,000
	130	5.3	87.4	168.3	6 / 10	5,000
	138	5.3	91.3	176.1	6 / 10	5,000
	142	5.3	93.3	180.1	6 / 10	5,000
	146	5.3	95.3	184.0	6 / 10	5,000
	157	5.3	103.1	195.8	6 / 6	4,900
	169	5.3	109.1	207.6	6 / 6	4,600
	177	5.3	113.0	215.5	6 / 6	4,300
	197	5.3	122.8	235.2	6 / 6	3,700
Two-stage ZZ	97	24.8	61.8	116.9	6 / 10	5,000
	98	34.7	71.7	136.5	6 / 10	5,000
	118	44.5	81.5	156.2	6 / 10	5,000
	130	50.4	87.4	168.0	6 / 10	5,000
	138	54.4	91.3	175.9	6 / 10	5,000
	142	56.3	93.3	179.8	6 / 10	5,000
	146	58.3	95.3	183.8	6 / 6	5,000
	157	66.2	103.1	195.6	6 / 6	4,800
Three-stage DZ	157	41.6	78.5	196.0	6 / 6	4,700
	171	46.5	83.5	209.8	6 / 6	4,400
	177	48.5	85.4	215.6	6 / 6	4,100
	189	52.4	89.6	227.4	6 / 6	3,800
	197	58.0	95.0	235.3	6 / 6	3,400
	217	67.2	104.2	255.0	3 / 6	2,800
	236	76.4	113.4	274.6	3 / 6	1,900
	256	85.6	122.6	294.3	3 / 3	1,100

Free lift height (no load-backrest) +16.7in

Mast Table FE4P60-70Q											
Designation	Lift height h3 (in)		Free lift h2 (in)		Closed mast height h1 (in)		Extended mast height h4 (in)		Tilt forward / backward a/b (°)		Capacity table (lb) C=24in without sideshift single pneumatic tires
	FE4P60Q	FE4P70Q	FE4P60Q	FE4P70Q	FE4P60Q	FE4P70Q	FE4P60Q	FE4P70Q	FE4P60Q	FE4P70Q	FE4P60Q FE4P70Q
Two-stage ZT	79	79	5.3	5.5	61.8	66.1	121.2	121.2	6 / 10	6 / 10	6,000 7,000
	98	98	5.3	5.5	71.7	76.0	140.9	140.9	6 / 10	6 / 10	6,000 7,000
	118	118	5.3	5.5	81.5	85.8	160.6	160.6	6 / 10	6 / 10	6,000 7,000
	130	130	5.3	5.5	87.4	91.7	172.4	172.4	6 / 10	6 / 10	6,000 7,000
	138	138	5.3	5.5	91.3	95.7	180.3	180.3	6 / 10	6 / 10	6,000 7,000
	142	142	5.3	5.5	93.3	97.6	184.2	184.2	6 / 10	6 / 10	6,000 7,000
	146	146	5.3	5.5	95.3	99.6	188.1	188.1	6 / 10	6 / 10	6,000 7,000
	157	157	5.3	5.5	103.1	107.5	200.0	200.0	6 / 6	6 / 6	5,900 6,900
	169	169	5.3	5.5	109.1	113.4	211.8	211.8	6 / 6	6 / 6	5,700 6,500
	177	177	5.3	5.5	113.0	117.3	219.6	219.6	6 / 6	6 / 6	5,200 6,200
	197	197	5.3	5.5	122.8	127.2	239.3	239.3	6 / 6	6 / 6	4,800 5,300
Two-stage ZZ	79	79	22.2	19.3	60.8	61.8	121.2	121.2	6 / 10	6 / 10	6,000 7,000
	98	98	32.0	29.2	70.7	71.7	140.9	140.9	6 / 10	6 / 10	6,000 7,000
	118	118	41.9	39.0	80.5	81.5	160.6	160.6	6 / 10	6 / 10	6,000 7,000
	130	130	47.8	44.9	86.4	87.4	172.4	172.4	6 / 10	6 / 10	6,000 7,000
	138	138	51.7	48.9	90.4	91.3	180.3	180.3	6 / 10	6 / 10	6,000 7,000
	142	142	53.7	50.8	92.3	93.3	184.2	184.2	6 / 10	6 / 10	6,000 7,000
	146	146	55.6	52.8	94.3	95.3	188.1	188.1	6 / 6	6 / 6	6,000 6,800
	157	157	63.5	60.7	102.2	103.1	200.0	200.0	6 / 6	6 / 6	5,900 6,700
Three-stage DZ	157	157	38.9	36.1	77.6	77.6	200.0	200.0	6 / 6	6 / 6	5,800 6,500
	169	169	43.8	41.0	82.5	82.5	211.8	211.8	6 / 6	6 / 6	5,500 6,300
	177	177	45.8	43.0	84.4	84.4	219.6	219.6	6 / 6	6 / 6	5,200 6,000
	189	189	49.7	46.9	88.4	88.4	231.5	231.5	6 / 6	6 / 6	4,800 5,600
	197	197	55.4	52.5	94.0	94.0	239.3	239.3	6 / 6	6 / 6	4,600 5,300
	217	217	64.6	61.7	103.2	103.2	259.0	259.0	3 / 6	3 / 6	3,700 4,400
	236	236	73.7	70.9	112.4	112.4	278.7	278.7	3 / 6	3 / 6	2,800 3,100
	256	256	83.0	80.1	121.6	121.6	298.4	298.4	3 / 3	3 / 3	1,800 1,900

Free lift height (no load-backrest) +16.7in

Identification					
1.1	Manufacturer		NOBLELIFT		
1.2	Model		FE4P50Q	FE4P60Q	FE4P70Q
1.3	Drive (electric – battery or mains, diesel, petrol, gas, manual)		Electric		
1.4	Type of operation (hand, pedestrian, standing, seated, order picker)		Seated forklift		
1.5	Load capacity / rated load	Q (lb)	5,000	6,000	7,000
1.6	Load center distance	c (in)	24		
1.8	Load distance, center of drive axle to fork	x (in)	18.8	19.2	19.4
1.9	Wheel base	y (in)	63.8	70.9	
Weights					
2.1	Service weight including battery (see line 6.5)	lb	7,920	8,954	9,856
2.2	Axle loading, laden front / rear	lb	12,100 / 1,320	14,508 / 1,496	15,708 / 1,848
2.3	Axle loading, unladen front / rear	lb	3,388 / 4,532	3,850 / 5,104	4,312 / 5,544
Wheels, Chassis					
3.1	Tires (solid rubber, superelastic, pneumatic, polyurethane)		Solid pneumatic		
3.2	Tire size, front		7.00-12-12PR	28x9-15-14PR	
3.3	Tire size, rear		6.00-9-10PR	6.50-10-10PR	
3.5	Wheels, number front / rear (x = driven wheels)		2x / 2		
3.6	Track width, front	b ₁₀ (in)	38.3	39.5	
3.7	Track width, rear	b ₁₁ (in)	38.7		
Basic Dimensions					
4.1	Mast / fork carriage tilt forward / backward	a/b (°)	6 / 10		
4.2	Lowered mast height	h ₁ (in)	81.5	81.5	86.0
4.3	Free lift	h ₂ (in)	5.3	5.5	5.7
4.4	Lift height	h ₃ (in)	118.1		
4.5	Extended mast height	h ₄ (in)	156.5	160.6	
4.7	Overhead load guard (cab) height	h ₆ (in)	84.6		
4.8	Seat height / standing height	h ₇ (in)	44.5		
4.12	Coupling height	h ₁₀ (in)	22.8		
4.19	Overall length	l ₁ (in)	140.5	148.5	150.3
4.20	Length to face of forks	l ₂ (in)	98.3	106.4	108.2
4.21	Overall width	bl (in)	45	48.3	
4.22	Fork dimensions	s/e/l (in)	1.6 / 4.7 / 42.1	1.8 / 4.9 / 42.1	2.0 / 4.9 / 42.1
4.24	Fork carriage width	b ₃ (in)	43.3		
4.31	Ground clearance, laden, under mast	m ₁ (in)	5.3		
4.32	Ground clearance, center of wheelbase	m ₂ (in)	5.9		
4.33	Aisle width for pallets 1000 x 1200 crossways	Ast (in)	151.5	160.6	162.3
4.34	Aisle width for pallets 800 x 1200 lengthways	Ast (in)	157.3	168.4	170.2
4.35	Turning radius	Wa (in)	86.6	94.5	96.1
Performance Data					
5.1	Travel speed, laden / unladen	mph	8.06 / 8.68		7.44 / 8.06
5.2	Lift speed, laden / unladen	fpm	61 / 79		59 / 77
5.3	Lowering speed, laden / unladen	fpm	<118		
5.5	Max. Drawbar pull, laden	blf	3,100	3,300	3,520
5.7	Max. Gradient performance, laden / unladen S2 5 min	%	15 / 15	13 / 15	
5.10	Service brake		Hydraulic		
E-Motor					
6.1	Drive motor rating S2 60 min	HP	14.7		
6.2	Lift motor rating at S3 15%	HP	21.4		
6.3	Battery standard		Lithium-iron phosphate		
6.4	Battery voltage, nominal capacity K5	V/Ah	80 / 300 option: 80 / 400		
6.5	Battery weight	lb	440	473	616
	Battery dimensions l/w/h	in	30.3 / 23.6 / 26.8	30.3 / 25.6 / 26.8	
	Charger standard	V/A	80 / 150 or 480V 3-phase		
	Operating Temperature	°F	-4 to 131		
Other Details					
8.1	Type of drive control		AC		
8.2	Operating pressure for attachments	psl	2,537.5		
8.3	Oil volume for attachments	gmp	570.6		
8.4	Sound level at driver's ear according to EN 12 053	dB(A)	74		75

A GLOBAL LEADER

NOBLELIFT is a global leader in Lithium-ion Technology. We manufacture more than 200 categories and around 30 series of each product. Our products are designed to meet different application demands and are well accepted by our customers in more than 100 countries and regions in Europe, America, Asia, Africa and more.

Products include: sit-down forklifts, narrow aisle forklifts, walkie-stackers, order pickers, electric pallet trucks, scissor lifts, tuggers, scrubbers, lift tables, manual pallet jacks and more.



FORKLIFTS



NARROW AISLE



STACKERS



POWERED PALLET TRUCKS



SCISSOR LIFTS



TUGGERS



SCRUBBERS

NOBLELIFT
NORTH AMERICA

2475 S. Wolf Road
Des Plaines, IL 60018
T: 847-595-7100
F: 847-595-7200
sales@nobeliftna.com
www.nobeliftna.com



Website

AUTHORIZED DEALER

